

(((THERMOLOGIC)))™

POWERED COLD-WEATHER GEAR



## THERMOLOGIC™ INSTRUCTION MANUAL HEATED GARMENT USER'S GUIDE

MODEL:

T-87102 HEATED BOMBER JACKET

T-930 HEATED PRIME LAYER VEST

T-931 HEATED PRIME LAYER JACKET

### IMPORTANT NOTICE:

Thank you for choosing ThermoLogic™ powered cold weather gear. As with any electrical device, misuse of a ThermoLogic garment or failure to follow instructions may cause overheating, fire or injury to you or your property. Please read garment labels and all instructions before using your ThermoLogic garment. Always keep the batteries out of reach of children.

### OVERVIEW

Battery Type	Lithium Ion 300+ recharging cycles
Battery Capacity	7.4V 2200maH
Battery Storage	Store at temperatures between 41°F (5°C) and 86°F (30°C). Ideal storage temperature is 68°-77°F (20°C-25°C)
Heating Method	Electric current pulsed through silver based printed ink
Temperature settings	High - 110°, Medium - 100°, Low - 85°
Heat times (estimated)	2.25 hours at High, 3.25 hours at Medium, 4.25 hours at Low
Charger	8.4V 1.2Amp output. 100V-240V input
Charging Time	2.5 hours

### CHARGING THE POWER-PAC

**HOW TO CHARGE** • Before initial use, fully charge the electronic power-pac. The power-pac houses the lithium ion battery. Insert plug into wall plug. Insert plug into power-pac. When the power-pac is charging, the light on the charger is red. The light will turn green part way through the charge cycle. Do not unplug prematurely, power-pac must charge the full length of time (see Overview) to be fully charged.

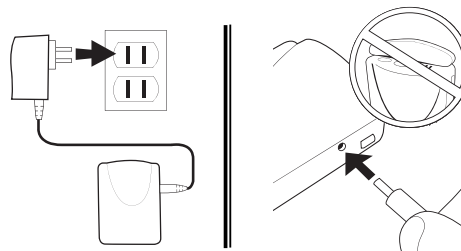

**WHEN TO RECHARGE** • Fully charge the power-pac before each use for best performance. The lithium ion battery in the power-pac will naturally discharge itself over time. It is best to charge it within two days of use. It is also recommended to fully charge the power-pac before storing it for extended periods of time. Store the power-pac in a dry, cool location – temperature no higher than 86°F (30°C).

The lithium ion battery inside the power-pac is rated for 300+ recharge cycles before you will need to replace it. Like other rechargeable batteries, these batteries may eventually require replacement. Contact ThermoLogic directly at 877-945-6837 or go to our website at [thermologicgear.com](http://thermologicgear.com) to order additional power-pacs.

### GETTING STARTED

**ASSEMBLY** • 1) Open the right lower pocket of the jacket or vest and insert the power-pac into the interior support pocket. Locate the clip sewn into the pocket interior.  
2) Insert clip into the power-pac. It clicks easily into place.

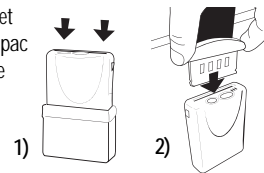

**ACTIVATION** • Press HEAT button to activate the power-pac. Make sure the power-pac is fully charged before initial use. The High (H) LED light will light showing that the temperature is set at High.

**TEMPERATURE ADJUSTMENT** • To change the heat setting, press the HEAT button. The LED light on the power-pac will switch from H (High), M (Medium) to L (Low) each time you push the HEAT Button. Whichever light is lit is the temperature setting selected.

**TO SHUT DOWN** • Press OFF button to turn off the power-pac. The LED light will go off. When you turn the power-pac on again, it will come on at the High setting. There is no low battery warning. When the batteries run down, the control unit will automatically shut off.  
**Extra power-pacs are available at [www.thermologicgear.com](http://www.thermologicgear.com)**

**TO RECHARGE** • Remove power-pac from the clip before recharging! Depress the two side buttons on either side of the power-pac and, at the same time, pull the clip out. The clip easily detaches from the power-pac. Follow instructions listed in "How to Charge?"

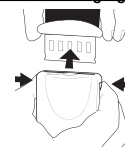

## WASH & CARE IMPORTANT!

**PREPARING GARMENT FOR WASHING** • Remove the power-pac from garment prior to washing. Follow instructions listed in "To Recharge" on how to remove the power-pac from the clip. The clip stays inside the garment and is not harmed by laundering. Do not try to remove it.

### WASHING INSTRUCTIONS:

Machine wash cold. Normal cycle. Wash separately. Do not bleach. Do not tumble dry. Line dry only. Do not iron. Do not dry clean. Allow to fully dry before connecting to power-pac. If the garment is still partly damp, it will not work.

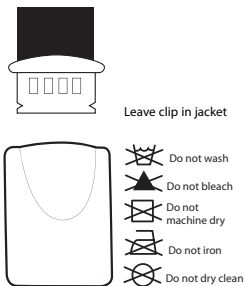

## WARNINGS AND SAFEGUARDS

### HEALTH

If you experience any discomfort while wearing this item, remove it immediately and consult your physician before resuming use.

Do not use if you have a pacemaker or defibrillator.

Check with your physician before use if you:

- Have a heart condition
- Have diabetes
- Have circulatory problems
- Have sensitivity to heat
- Are pregnant
- Are under 13 years of age

### ADDITIONAL WARNINGS

- Do not submerge ThermoLogic garment in water while wearing.
- Keep power-pac in waterproof pocket at all times. This ensures safety and reliability when wearing garment in the rain.
- Do not cut, puncture or tear the lining of the ThermoLogic garment. The linings include printed heating traces that may be damaged and may affect the heating ability or your ThermoLogic garment.
- Special care should be taken to prevent damage to the electronic components of your ThermoLogic garment. This includes the clip, power-pac and charger.
- Keep power-pac used with your ThermoLogic garment dry at all times. If the power-pac gets wet, do not turn it on. Allow it to dry completely in a cool, dry space and try activating the power-pac before re-inserting into your garment. Like any electrical items, the power-pac may be damaged if submerged in water.
- Keep all electronic components used with your ThermoLogic garment away from fire and significant sources of heat.
- Store in-doors away from direct heat sources. (See battery storage guidelines in Overview section.) Garment and components may not activate if frozen or stored in extreme cold. Should that happen, allow them to thaw and/or warm up before attempting to activate.
- When turned on, this garment may affect compasses or magnetic sensing equipment.
- Do not wear your ThermoLogic garment while sleeping.
- Your ThermoLogic garment is not intended for use in warm weather. Using your ThermoLogic garment at temperatures above 65°F may place YOU at risk of overheating.
- If you are going to store your ThermoLogic power-pac for long periods of time (in between seasons) we recommend that you fully charge it before storage.

PLEASE REVIEW YOUR WARRANTY. ANY MISUSE OF YOUR THERMOLOGIC GARMENT WILL VOID YOUR WARRANTY.

## THERMOLOGIC 1 YEAR LIMITED WARRANTY

NTA Enterprises, Inc. ("NTA") warrants to the original retail purchaser that this ThermoLogic™ garment (the "Product") will be free of defects in materials and workmanship for a period of one (1) year from the date of initial purchase (the "Warranty Period"). NTA, at its option, will repair or replace the Product, or any part of the Product, that is defective during the warranty period. Replacements will be made with a new or remanufactured Product. If the Product is no longer available, NTA may replace the Product with a similar product of equal or greater value.

This LIMITED WARRANTY is the exclusive warranty for the Product and it is valid only during the Warranty Period to the original retail purchaser and is not transferable. Proof of purchase is required to obtain performance of this LIMITED WARRANTY. Proof of purchase may be provided to us with the original sales receipt for the product, through registration on NTA's website [thermologicgear.com](http://thermologicgear.com) or by returning the attached warranty card. Retailers and other resellers of the Product do not have authority to alter, modify, amend or otherwise change the terms of this warranty.

This LIMITED WARRANTY does **NOT** cover damage or wear resulting from negligent use or misuse of the Product, use with any battery not provided or approved by NTA for use with the Product, use contrary to the operating instructions of the Product, disassembly or repair or alteration by anyone other than NTA or its authorized agent.

NTA DISCLAIMS ALL OTHER WARRANTIES, EXPRESS OR IMPLIED, EXCEPT TO THE EXTENT PROHIBITED BY APPLICABLE LAW. IF REQUIRED AND PERMITTED BY LAW, ANY IMPLIED WARRANTY IS LIMITED IN DURATION TO ONE (1) YEAR FROM THE DATE OF INITIAL RETAIL PURCHASE. NTA SHALL NOT BE LIABLE FOR ANY INCIDENTAL OR CONSEQUENTIAL DAMAGES RESULTING FROM ANY ALLEGED BREACH OF WARRANTY. SOME STATES DO NOT ALLOW THE EXCLUSION OR LIMITATION OF CONSEQUENTIAL DAMAGES OR A LIMITATION ON THE DURATION OF AN IMPLIED WARRANTY, SO THE ABOVE LIMITATIONS MAY NOT APPLY TO YOU.

THIS WARRANTY GIVES YOU SPECIFIC LEGAL RIGHTS AND YOU MAY HAVE RIGHTS THAT VARY FROM STATE TO STATE.

## SERVICE INSTRUCTIONS

### TO OBTAIN WARRANTY SERVICE:

Do not return the product to place of purchase for warranty service. If you have any problems, questions or to obtain instructions for returning the product to us for warranty service, contact us through our website at [thermologicgear.com](http://thermologicgear.com) or call us at 1-877-945-6837. We are here to help.

**TROUBLESHOOTING** • The ThermoLogic power-pac comes with several built-in safety features:

- If the jacket is exposed to a large burst of static electricity, the power-pac will temporarily go into standby mode to protect the electronics. You will know that the control unit has shifted to this mode if the temperature lights start flashing H,M,L, H,M,L. **If this occurs**, simply press the OFF button, wait a few seconds, then press HEAT. The unit will then reset to the High mode, and you can change the setting as you please. Depending on the static electricity in the area, this step may need to be repeated.
- If the lights flash H,M,L and then all blink together at once, this is a sign that there is a puncture or break in the jacket. The power-pac will lock down into a safety mode. If this happens, please call us at 1-877-945-6837.

VISIT [WWW.THERMOLOGICGEAR.COM](http://WWW.THERMOLOGICGEAR.COM) FOR FURTHER ADVICE.



POWERED COLD - WEATHER GEAR

Heated by

