

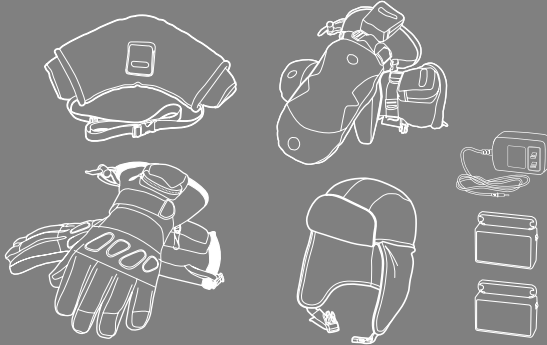

POWERED COLD - WEATHER GEAR



**THERMOLOGIC™ INSTRUCTION MANUAL**  
HEATED ACCESSORY USER'S GUIDE

MODEL:

T-137 HEATED GLOVE

T-174 HEATED MITTEN

T-175 HEATED MUFF

T-580 HEATED HAT

**IMPORTANT NOTICE:**

Thank you for choosing ThermoLogic™ powered cold weather gear. As with any electrical device, misuse of a ThermoLogic accessory or failure to follow instructions may cause overheating, fire or injury to you or your property. Please read accessory labels and all instructions before using your ThermoLogic accessory. Always keep the batteries out of reach of children.

**OVERVIEW**

Battery Type	Lithium Ion 300+ recharging cycles
Battery Capacity	3.7V 2200mAh Lithium Ion
Battery Storage	Store at temperatures between 41°F (5°C) and 86°F (30°C). Ideal storage temperature is 68°-77°F (20°C-25°C)
Heating Method	Electric current pulsed through silver based printed ink
Temperature settings	High - 110°, Medium - 100°, Low - 85°
Heat times (estimated)	2.25 hours at High, 3.25 hours at Medium, 4.25 hours at Low
Charger	4.2V 1.5Amp output. 100V-240V Input
Charging Time	Gloves/Mittens: 4 hours Hat/Muff: 3 hours

**CHARGING THE POWER-PAC**

**HOW TO CHARGE** • Before initial use, fully charge the electronic power-pacs. The power-pacs house the lithium ion batteries.

**GLOVE/MITTEN CHARGER:** this has a split cord so you can charge both power-pacs at the same time. Power-pacs can also be charged individually. If you chose to charge only one at a time, do not plug in the second unit midway through the charging cycle. This can be damaging to the batteries.

**HAT/MUFF CHARGER:** this only has one cord as there is just one power-pac per hat/muff. Insert plug into wall plug. Insert plug into power-pac.

**NOTE:** When the power-pacs are charging, the light on the charger is red. The light will turn green part way through the charge cycle. Do not unplug prematurely, power-pacs must charge the full length of time (see Overview) to be fully charged.

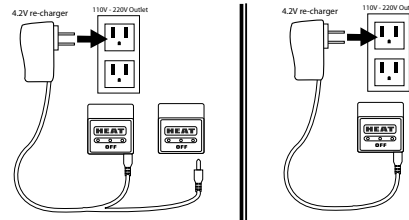

**WHEN TO RECHARGE** • Fully charge the power-pac before each use for best performance. The lithium ion battery in the power-pac will naturally discharge itself over time. It is best to charge it within two days of use. It is also recommended to fully charge the power-pacs before storing them for extended periods of time. Store the power-pac in a dry, cool location – temperature no higher than 86°F (30°C).

The lithium ion battery inside the power-pac is rated for 300+ recharge cycles before you will need to replace it. Like other rechargeable batteries, these batteries may eventually require replacement. Contact ThermoLogic directly at 877-945-6837 or go to our website at [thermologicgear.com](http://thermologicgear.com) to order additional power-pacs.

**GETTING STARTED**

**ASSEMBLY** • 1) Open the zipper pocket. 2) Locate the clip sewn into the pocket. Hold the clip on both sides with one hand while the other hand holds the power-pac. Insert clip into the power-pac. It clicks easily into place. Do not twist the clip. Make sure the temperature controls are visible when connecting the clip. 3) Close the zipper pocket.

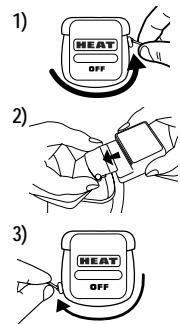

**ACTIVATION** • Press and release the HEAT button (press on the word Heat printed on the outside of the pocket). By pressing and releasing here you will activate the Heat button on the power-pac inside the pocket. The High (H) LED light will illuminate showing that the unit is on and the temperature is set to High.

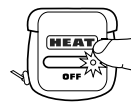

**TEMPERATURE ADJUSTMENT** • To change the heat setting, press and release the HEAT button (press on the word Heat printed on the outside of the pocket) to toggle between heat settings. The LED light on the power-pac will switch from H (High), to M (Medium) to L (Low) each time you press and release the HEAT button. Whichever light is lit is the temperature setting selected. You can see the LED light through the clear PVC window on the pocket.



**TO SHUT DOWN** • Press and release the OFF button (press on the word Off printed on the outside of the pocket). By pressing here you will turn the power-pac off. The LED light will turn off. When the power-pac runs low, it will flash H, M, L individually then all together. This indicates it is time to recharge the power-pac. Extra power-pacs are available at [www.thermologicgear.com](http://www.thermologicgear.com)

**TO RECHARGE** • Remove the power-pac from the clip before recharging. Hold the clip on both sides with one hand while the other hand holds the power-pac and gently pulls it away from the clip. See Illus. 2 above. The clip easily detaches from the power-pac. Do not twist the clip. Follow instructions listed in "How to Charge"

## WASH & CARE IMPORTANT!

**PREPARING ACCESSORY FOR WASHING** • Remove power-pacs from accessory prior to washing. Follow instructions listed in "To Recharge" on how to remove the power-pac from the clips. The clip stays inside the accessory and is not harmed by laundering. Do not try to remove it.

### WASHING INSTRUCTIONS:

Machine wash cold. Normal cycle. Wash separately. Do not bleach.

**Do not tumble dry. Line dry only.** Do not iron. Do not dry clean. Allow to fully dry before connecting to power-pac. If accessory is still partly damp, it will not work.

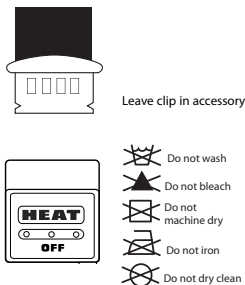

## WARNINGS AND SAFEGUARDS

### HEALTH

If you experience any discomfort while wearing this item, remove it immediately and consult your physician before resuming use.

Do not use if you have a pacemaker or defibrillator.

Check with your physician before use if you:

- Have a heart condition
- Have diabetes
- Have circulatory problems
- Have sensitivity to heat
- Are pregnant
- Are under 13 years of age

### ADDITIONAL WARNINGS

- Do not submerge ThermoLogic accessory in water while wearing.
- Keep power-pac in waterproof pocket at all times. This ensures safety and reliability when wearing accessory in the rain.
- Do not cut, puncture or tear the lining of the ThermoLogic accessory. The linings include printed heating traces that may be damaged and may effect the heating ability of your ThermoLogic accessory.
- Special care should be taken to prevent damage to the electronic components of your ThermoLogic accessory. This includes the clip, power-pac and charger.
- Keep power-pac used with your ThermoLogic accessory dry at all times. If the power-pac gets wet, do not turn it on. Allow it to dry completely in a cool, dry space and try activating power-pac before re-inserting into your accessory. Like any electrical item, power-pac may be damaged if submerged in water.
- Keep all electronic components used with your ThermoLogic accessory away from fire and significant sources of heat.
- Store in-doors away from direct heat sources. (See battery storage guidelines in Overview section.) Accessory and components may not activate if frozen or stored in extreme cold. Should that happen, allow them to thaw and/or warm up before attempting to activate.
- When turned on, this accessory may affect compasses or magnetic sensing equipment.
- Your ThermoLogic accessory is not intended for use in warm weather. Using your ThermoLogic accessory at temperatures above 65°F may place YOU at risk of overheating.
- If you are going to store your ThermoLogic power-pac for long periods of time ( in between seasons ) we recommend that you fully charge the power-pac before storage.

PLEASE REVIEW YOUR WARRANTY. ANY MISUSE OF YOUR THERMOLOGIC ACCESSORY WILL VOID YOUR WARRANTY.

## THERMOLOGIC 1 YEAR LIMITED WARRANTY

NTA Enterprises, Inc. ("NTA") warrants to the original retail purchaser that this ThermoLogic™ Accessory (the "Product") will be free of defects in materials and workmanship for a period of one (1) year from the date of initial purchase (the "Warranty Period"). NTA, at its option, will repair or replace the Product, or any part of the Product, that is defective during the warranty period. Replacements will be made with a new or remanufactured Product. If the Product is no longer available, NTA may replace the Product with a similar product of equal or greater value.

This **LIMITED WARRANTY** is the exclusive warranty for the Product and it is valid only during the Warranty Period to the original retail purchaser and is not transferable. Proof of purchase is required to obtain performance of this LIMITED WARRANTY. Proof of purchase may be provided to us with the original sales receipt for the product, through registration on NTA's website [thermologicgear.com](http://thermologicgear.com) or by returning the attached warranty card. Retailers and other resellers of the Product do not have authority to alter, modify, amend or otherwise change the terms of this warranty.

This **LIMITED WARRANTY** does **NOT** cover damage or wear resulting from negligent use or misuse of the Product, use with any battery not provided or approved by NTA for use with the Product, use contrary to the operating instructions of the Product, disassembly or repair or alteration by anyone other than NTA or its authorized agent.

NTA DISCLAIMS ALL OTHER WARRANTIES, EXPRESS OR IMPLIED, EXCEPT TO THE EXTENT PROHIBITED BY APPLICABLE LAW. IF REQUIRED AND PERMITTED BY LAW, ANY IMPLIED WARRANTY IS LIMITED IN DURATION TO ONE (1) YEAR FROM THE DATE OF INITIAL RETAIL PURCHASE. NTA SHALL NOT BE LIABLE FOR ANY INCIDENTAL OR CONSEQUENTIAL DAMAGES RESULTING FROM ANY ALLEGED BREACH OF WARRANTY. SOME STATES DO NOT ALLOW THE EXCLUSION OR LIMITATION OF CONSEQUENTIAL DAMAGES OR A LIMITATION ON THE DURATION OF AN IMPLIED WARRANTY, SO THE ABOVE LIMITATIONS MAY NOT APPLY TO YOU.

THIS WARRANTY GIVES YOU SPECIFIC LEGAL RIGHTS AND YOU MAY HAVE RIGHTS THAT VARY FROM STATE TO STATE.

## SERVICE INSTRUCTIONS

### TO OBTAIN WARRANTY SERVICE:

Do not return the product to place of purchase for warranty service.

If you have any problems, questions or to obtain instructions for returning the product to us for warranty service, contact us through our website at [thermologicgear.com](http://thermologicgear.com) or call us at 1-877-945-6837. We are here to help.

**TROUBLESHOOTING** • The ThermoLogic power-pac comes with several built-in safety features:

- If the accessory is exposed to a large burst of static electricity, the power-pac will temporarily go into standby mode to protect the electronics. You will know that the power-pac has shifted to this mode if the temperature lights start flashing H,M,L, H,M,L. **If this occurs**, simply press the OFF button, wait 5 seconds, then press the HEAT button to re-activate. The power-pac will then reset to the High mode, and you can change the setting as you please. Depending on the static electricity in the area, this step may need to be repeated.
- If the lights flash H,M,L and then all blink together at once, this is a sign that the power-pac needs to be recharged **OR** there is a puncture or break in the accessory. The power-pac will turn off.

**If this happens, A) Recharge the power-pac. B) For Gloves/mittens, turn the power off, remove the module, and try to plug it into the other glove and re-start. This will re-set the power-pac. Remove the power-pac and re-attach it to the original position. If the same light sequence occurs, this means that there has been some damage to the accessory.**

